

A Assembly of the Bin

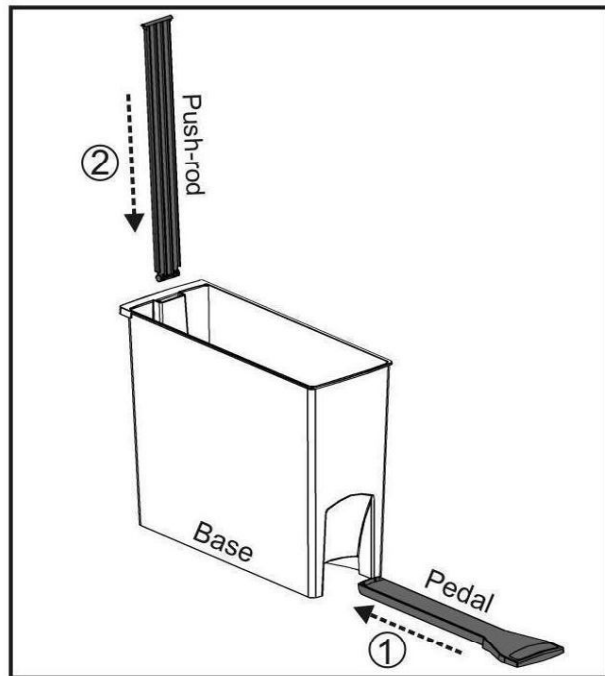

- ① Slide in the pedal into the front of the Base, small end first.
- ② Slide down the push-rod, small end first, through the hole at the top of the Base at the back.

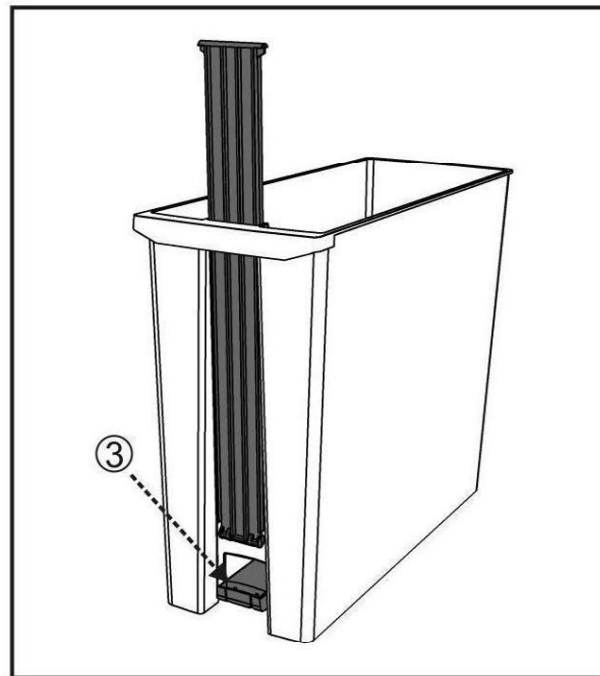

- ③ Bring the end of the push-rod down to meet the 'cup' at the end of the pedal as indicated above.

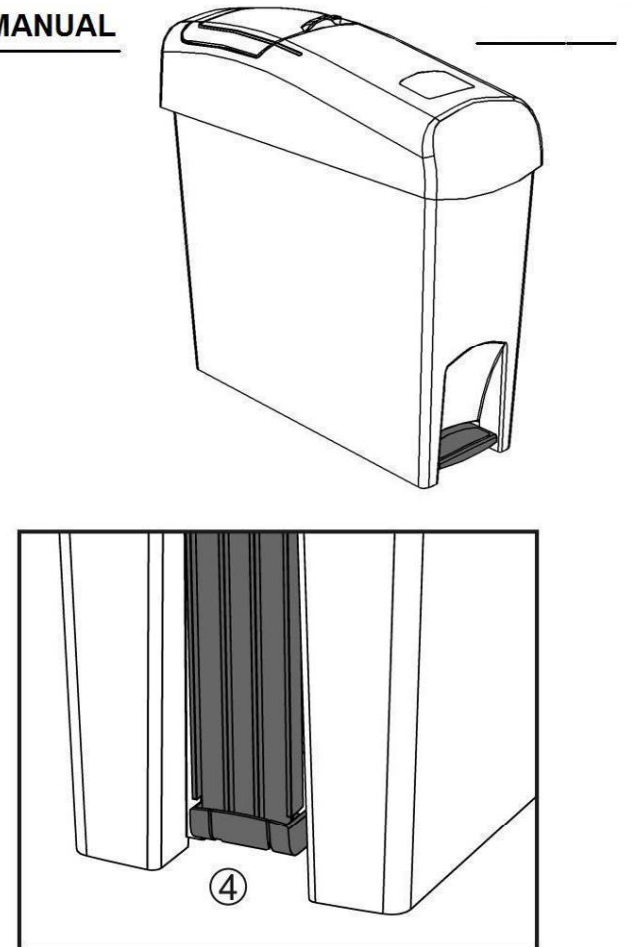

- ④ Press down on the push-rod so that it 'snaps' into the pedal and locks in place as shown above.

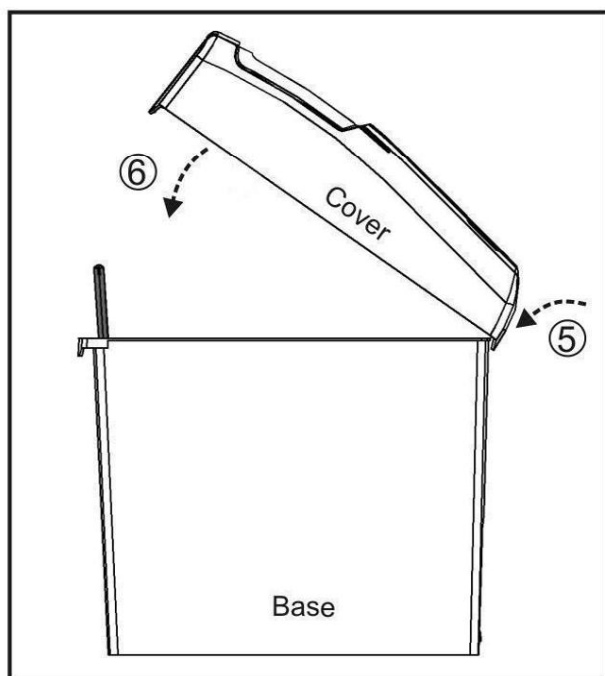

- ⑤ Bring the front of the cover up to the front edge of the bin base. Hook the cover onto the top edge of the base.
- ⑥ Rotate the back of the cover down to the back of the base.

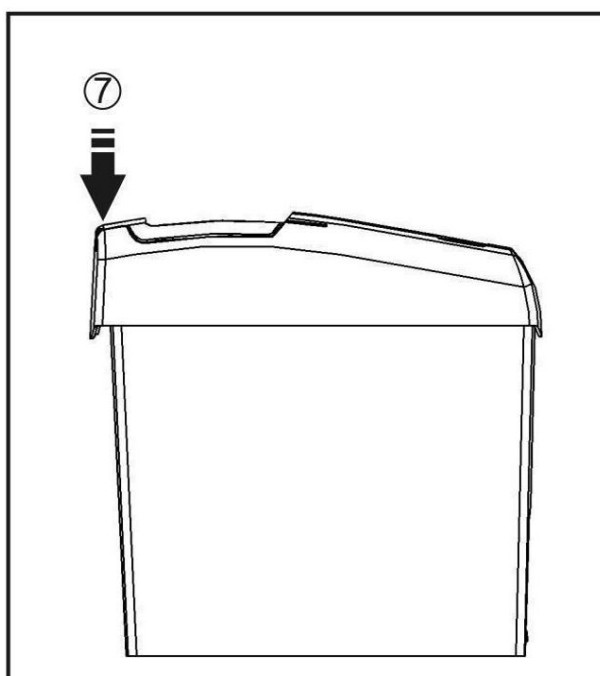

- ⑦ Press down on the back of the cover until it 'snaps' shut

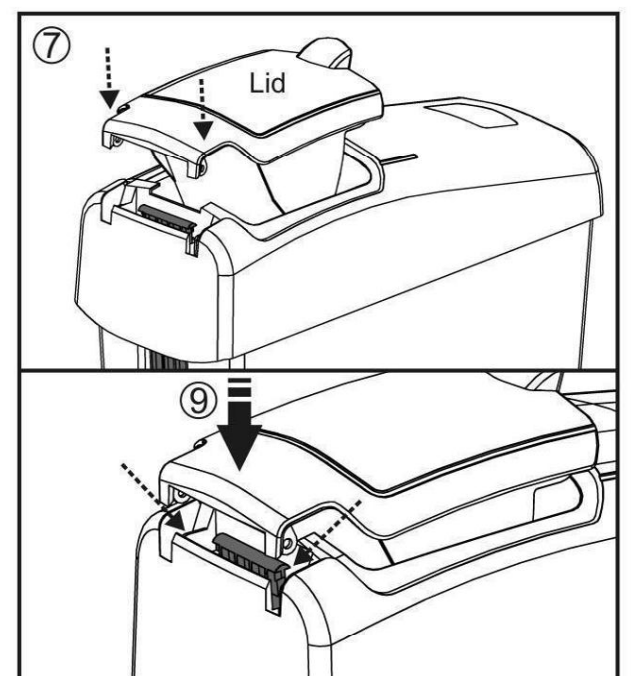

- ⑧ Slide the tray part of the lid down into the cover.
- ⑨ Align the hinge of the lid with the hinge of the cover and press down so it 'snaps' into place.

B Removing the Cover

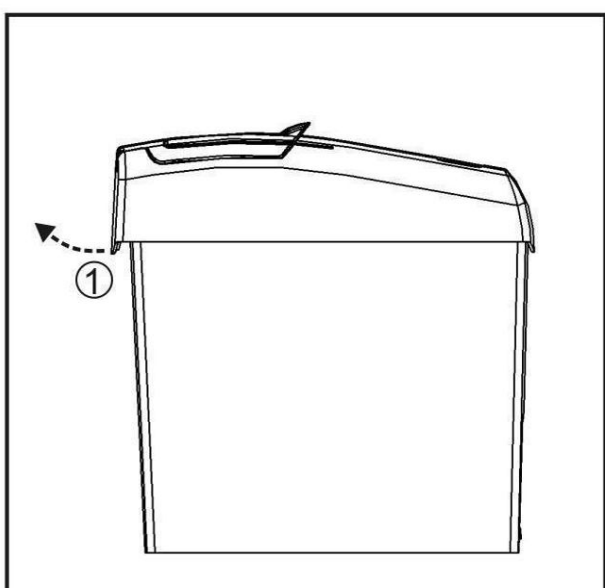

- ① Pull the lower edge of the cover backwards to 'un-clip'.

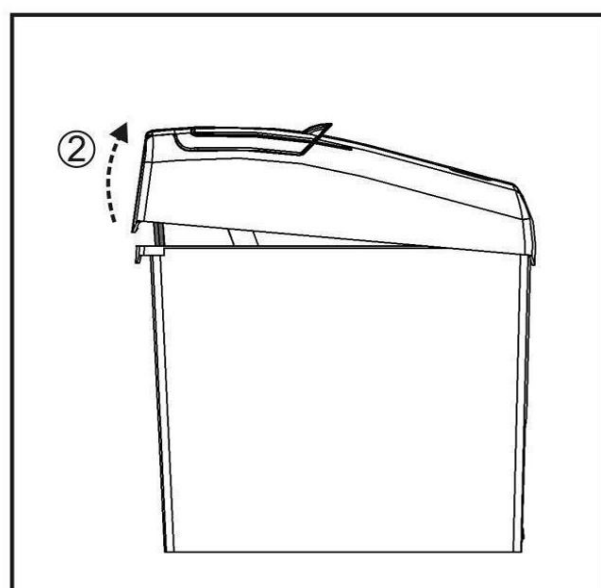

- ② Rotate the back of the cover upwards.

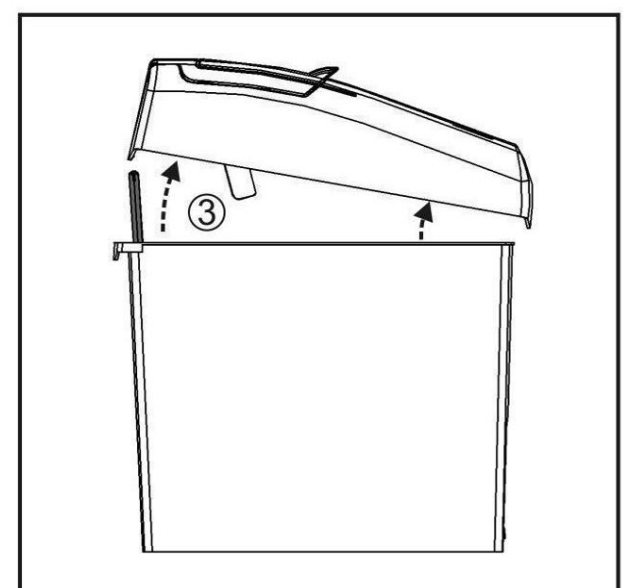

- ③ Lift the cover all the way up so that the front catch releases.